

MV-CH500-61CM

50 MP CCD Camera Link Area Scan Camera



GEN*i*CAM



Introduction

MV-CH500-61CM camera adopts OnSemi KAI-50140 sensor to provide high-quality image. It uses Camera Link interface to transmit non-compressed images in real time with max. frame rate reaching 4 fps. The camera adopts TEC to keep the camera's sensor temperature around environment temperature.

Key Feature

- Resolution of 10440 × 4800 and pixel size of 4.5 μm × 4.5 μm.
- Adopts global shutter CCD sensor providing wide dynamic range and high-quality image.
- Supports configuration modes of Base and Medium via the Camera Link interface.
- Adopts compact design with mounting holes for flexible mounting.

Available Model

MV-CH500-61CM-M58S-TF

Applicable Industry

FPD, electronics and semiconductor inspection, research and scientific imaging, microscopy and metrology, etc.

Sensor Quantum Efficiency

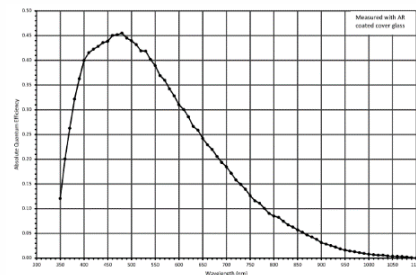

Dimension

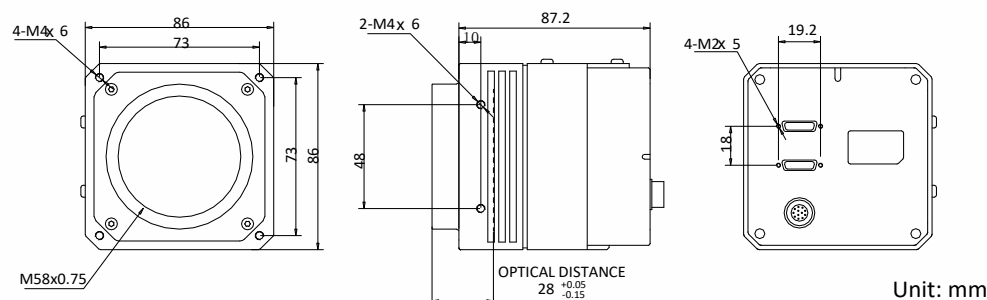

Specification

Model	MV-CH500-61CM
Camera	
Sensor type	CCD, global shutter
Sensor model	OnSemi KAI-50140
Pixel size	4.5 μm \times 4.5 μm
Sensor size	46.98 mm \times 21.6 mm
Resolution	10440 \times 4800
Configuration mode	Base, Medium
Tap geometry	1X_2YE, 1X2_2YE
Tap number	2 Taps, 4 Taps
Max. frame rate	4 fps @10440 \times 4800
Pixel clock	85 MHz
Dynamic range	60 dB
SNR	40 dB
Gain	0 dB to 20 dB
Exposure time	102 μs to 10 sec
Mono/color	Mono
Pixel format	Mono 8/10/12
Exposure mode	Off/Once/Continuous exposure mode
Binning	Not support
Decimation	Not support
Reverse image	Supports horizontal reverse image output
Electrical feature	
Data interface	Camera Link with SDR interface
Digital I/O	12-pin Hirose connector provides power and I/O, including opto-isolated input \times 1 (Line 0), opto-isolated output \times 1 (Line 1), bi-directional non-isolated I/O \times 1 (Line 2), RS-232 \times 1
Power supply	22 VDC to 26 VDC
Power consumption	Typ. 18 W@24 VDC (non-TEC cooling mode)
	Typ. 70 W@24 VDC (TEC cooling mode)
Mechanical	
Lens mount	M58*0.75, optical back focal length 28 mm (1.1")
Dimension	86 mm \times 86 mm \times 87.2 mm (3.4" \times 3.4" \times 3.4")
Weight	Approx. 1300 g (2.9 lb.)
Ingress protection	IP40 (under proper lens installation and wiring)
Temperature	Working temperature: 0 $^{\circ}\text{C}$ to 50 $^{\circ}\text{C}$ (32 $^{\circ}\text{F}$ to 122 $^{\circ}\text{F}$)
	Storage temperature: -30 $^{\circ}\text{C}$ to 70 $^{\circ}\text{C}$ (-22 $^{\circ}\text{F}$ to 158 $^{\circ}\text{F}$)
Humidity	20% to 95% RH, non-condensing
General	
Client software	MVS or frame grabber software meeting with GenICam Protocol
Operating system	32/64-bit Windows XP/7/10
Compatibility	Camera Link Vision, GenICam
Certification	CE, FCC, RoHS, KC

HIKROBOT

Hangzhou Hikrobot Technology Co., Ltd.

No.399 Danfeng Road, Binjiang District, Hangzhou 310051, China.

en.hikrobotics.com

Copyright Hikrobot

Hangzhou Hikrobot Technology Co., Ltd. All Rights Reserved. Hangzhou Hikrobot Technology does not tolerate any infringement. Any organization or individual may not imitate or reproduce in whole or in part of the content. The data herein is based on Hikrobot's internal evaluation. Actual data may vary depending on specific configuration and operating condition. The information herein is subject to change without notice. All the content has been checked conscientiously. Nevertheless, Hikrobot shall not be liable to damages resulting from errors, inconsistencies or omissions.