

MV-CH290-61CM

29 MP CCD Camera Link Area Scan Camera



GEN*i*CAM



Introduction

MV-CH290-61CM camera adopts OnSemi KAI-29050 sensor to provide high-quality image. It uses Camera Link interface to transmit non-compressed images in real time with max. frame rate reaching 4.5 fps.

Key Feature

- 29 MP resolution, pixel size of 5.5 μm
- High quality CCD sensor with ultra-high signal-to-noise ratio, wide dynamic range, excellent imaging quality
- Camera Link interface, support Base and Medium mode
- Supports serial port communication, and communication protocol RS-232
- Compact construction design with mounting holes on the up and bottom panels for flexible mounting

Available Model

- M58 mount with fan, mono camera: MV-CH290-61CM-M58S-NF
- F mount with fan, mono camera: MV-CH290-61CM-F-NF

Applicable Industry

SMT/PCB AOI, FPD detection, railway related applications, etc.

Sensor Quantum Efficiency

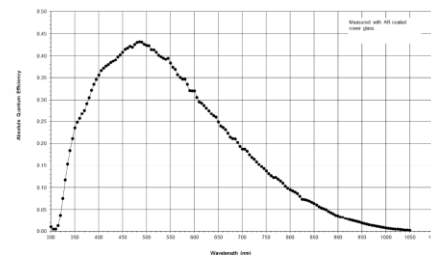

Specification

| | | | |
|--------------------|---|--------|---------|
| Model | MV-CH290-61CM | | |
| Camera | | | |
| Sensor type | CCD, global shutter | | |
| Sensor model | OnSemi KAI-29050 | | |
| Pixel size | 5.5 μm × 5.5 μm | | |
| Sensor size | 36 mm × 24 mm | | |
| Resolution | 6576 × 4384 | | |
| Configuration mode | Base | | Medium |
| Tap geometry | 1X_1Y | 1X_2YE | 1X2_2YE |
| Tap number | 1 Tap | 2 Taps | 4 Taps |
| Max. frame rate | 4.5 fps @6576 × 4384 | | |
| Pixel clock | 85 MHZ | | |
| Dynamic range | 64 dB | | |
| SNR | 40 dB | | |
| Gain | 0 dB to 20 dB | | |
| Exposure time | 103 μs to 2 sec | | |
| Mono/color | Mono | | |
| Pixel format | Mono 8/10/12 | | |
| Exposure mode | Off/Once/Continuous exposure mode | | |
| Binning | Supports 1 × 1, 1 × 2, 1 × 4, 2 × 1, 2 × 2, 2 × 4, 4 × 1, 4 × 2, 4 × 4 | | |
| Decimation | Not support | | |
| Reverse image | Supports horizontal reverse image output | | |
| Electrical feature | | | |
| Data interface | Camera Link with SDR interface | | |
| Digital I/O | 12-pin Hirose connector provides power and I/O, including opto-isolated input × 1 (Line 0), opto-isolated output × 1 (Line 1), bi-directional non-isolated I/O × 1 (Line 2), RS-232 × 1 | | |
| Power supply | 12 VDC | | |
| Power consumption | Typ. 11 W@12 VDC | | |
| Mechanical | | | |
| Lens mount | M58 mount, optical back focal length 11.48 mm (0.5") F mount, optical back focal length 46.5 mm (1.8") | | |
| Dimension | M58 mount with fan: 74 mm × 74 mm × 74.1 mm (2.9" × 2.9" × 2.9") F mount with fan: 74 mm × 74 mm × 80.5 mm (2.9" × 2.9" × 3.2") | | |
| Weight | M58 mount with fan: < 450 g (1.0 lb.) F mount with fan: < 600 g (1.4 lb.) | | |
| Ingress protection | IP40 (under proper lens installation and wiring) | | |
| Temperature | Working temperature: 0 °C to 50 °C (32 °F to 122 °F) Storage temperature: -30 °C to 70 °C (-22 °F to 158 °F) | | |
| Humidity | 20% to 95% RH, non-condensing | | |
| General | | | |
| Client software | MVS or frame grabber software meeting with GenICam Protocol | | |
| Operating system | 32/64-bit Windows XP/7/10 | | |
| Compatibility | Camera Link V2.0, GenICam | | |
| Certification | CE, FCC, RoHS, KC | | |

Dimension

M58 Mount with fan:

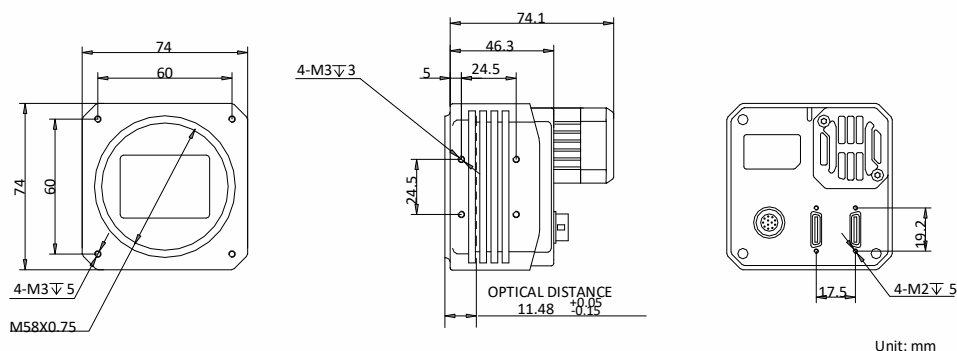

F Mount with fan:

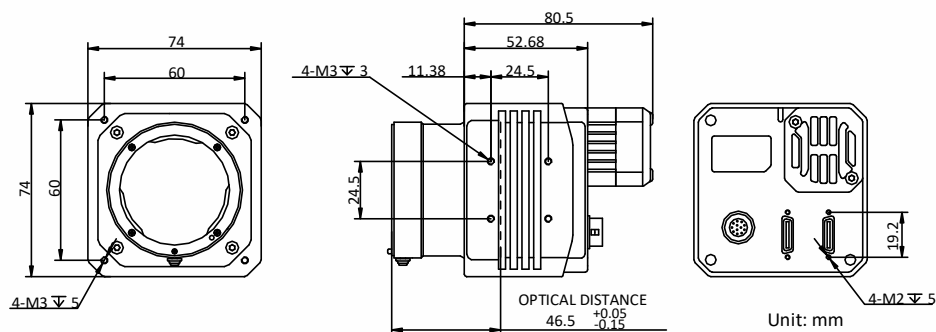

HIKROBOT

Hangzhou Hikrobot Technology Co., Ltd.
No.399 Danfeng Road, Binjiang District, Hangzhou 310051, China.
en.hikrobotics.com

Copyright Hikrobot

Hangzhou Hikrobot Technology Co., Ltd. All Rights Reserved. Hangzhou Hikrobot Technology does not tolerate any infringement. Any organization or individual may not imitate or reproduce in whole or in part of the content. The data herein is based on Hikrobot's internal evaluation. Actual data may vary depending on specific configuration and operating condition. The information herein is subject to change without notice. All the content has been checked conscientiously. Nevertheless, Hikrobot shall not be liable to damages resulting from errors, inconsistencies or omissions.